

Gaspo 254 Lift Assisted Energy Distribution Tower

SIMPLE DESIGN

Lift assisted manual tower with
2 x 16A 230V sockets pre
installed

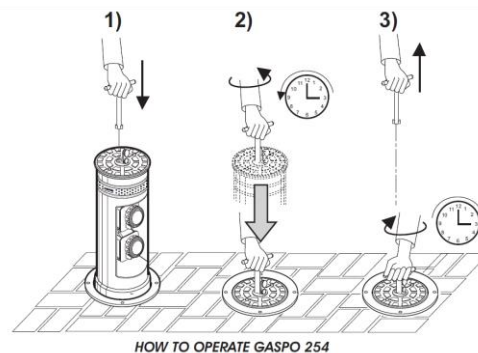
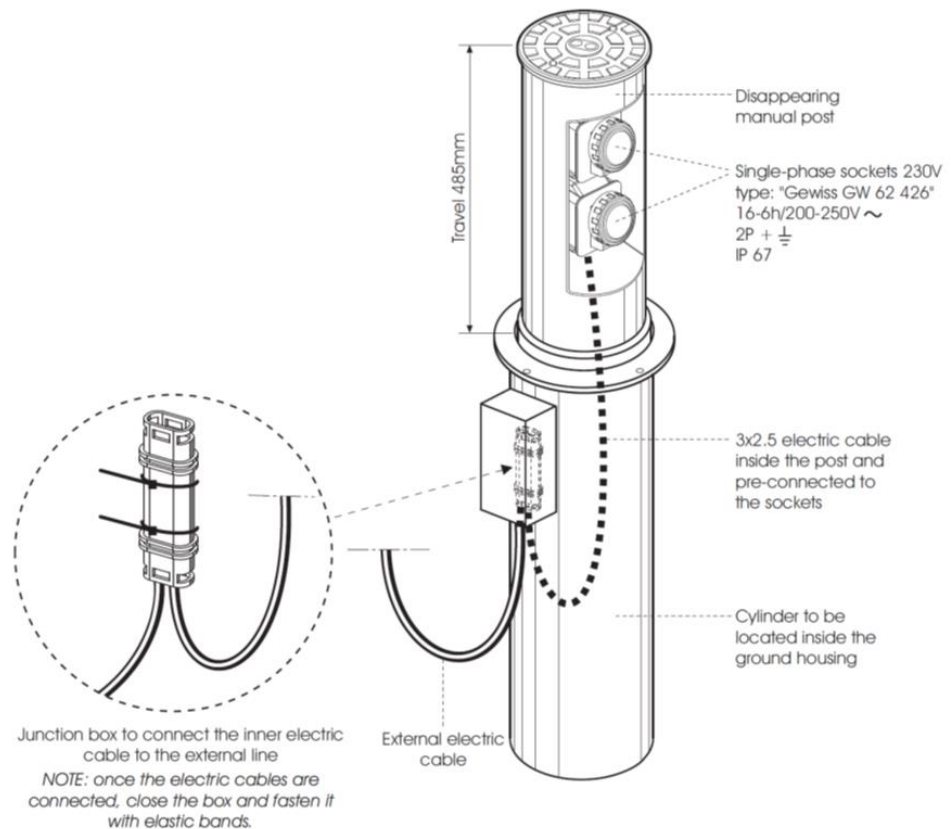

Specifications

Diameter	200mm
Height	485mm
Sockets	2 x 16A 230V

Macs Automated Bollard Systems Ltd
Unit 8.1b Tameside Business Park
Windmill Lane, Denton
Manchester, M34 3QS

Tel: 0161 3206462
Email: enquiries@macs-bollards.com
Web: www.macs-bollards.com